

3210HD Series

Temperature Measurement Thermographic System



3212-2001



3212-9000

Advanced Thermal Performance

- IRFPA uncooled microbolometer technology
- 400 x 300 resolution
- Superior thermal sensitivity of <40mK
- On-board temp-detection algorithm
- Accuracy 0.3°C or 0.5°F
- Body detection
- Response time 30ms
- 17 color palettes

Superior Daytime Imaging

- Visible spectrum daytime color camera
- HD 1920 x 1080 image quality
- Autofocus, wide view optics
- Supports daytime thermal imaging for improved situational awareness

Rugged Construction

- Wide operating temperature range
- Durable IP66 ingress protection*
- 2 year standard warranty

Installation and Interoperability

- Network IP Video and Management
- ONVIF Profile G support
- H.265/H.264 and MJPEG encoding
- Single CAT5e/CAT6 cable with PoE
- Wall, ceiling, and tripod mounting options
- NDAA Compliant*

CohuHD Costar is proud to showcase our latest intelligent Thermal Imaging Radiometric Detection and Thermal Measurement system.

The CohuHD Costar 3210HD series is a state-of-the-art thermographic system boasting both optical and thermal imagers.

Using internal analytics, the 3210HD Series cameras produce a visible light image with thermal data overlaid on the image.

Within a predefined alert area if the reading exceeds a specified temperature a virtual box will turn red and flash the capture value on the screen.

The 3210HD series is ONVIF profile G compliant to ensure easy operation and integration with third party VMS platforms already on the market.

When installed with the 3212-9000 Thermal Calibration Reference Device, consistent temperature readings can be captured with a high degree of accuracy.

Thermographic cameras are typically used in a variety of applications including schools, retail, finance, assisted living, transportation, or commercial activities.

When used as part of a wholistic system for screening, no solution is better positioned to deliver trusted and accurate results.

The 3210HD Series system includes one or more 3212-2000 cameras, software or smart NVR platform, and a 3212-9000 Thermal Calibration Reference Device. The system is expandable into a multi-point solution. The 3210HD Series is backed by a world-class two-year warranty.



youtube.com/CohuHD
linkedin.com/company/CohuHD
twitter.com/CohuHD
facebook.com/CohuHD
CohuHD.com

©CohuHD Costar™, LLC reserves the right to change specifications without notice

(858) 391-1800

* Camera only.

3212-2001 THERMAL & VISIBLE DUAL SENSOR CAMERA

THERMAL CAMERA

Detector	Uncooled IRFPA
Resolution/Pixel Size	400 x 300/17µm
Spectral Band	8 - 14µm
Sensitivity (NEdT)	40mK @ F1.0
Frame Rate	25Hz
Image	Polarity LUT, DVE, Mirror, FCC, 3D DNR Brightness, Contrast, ROI
Palettes	Black-Heat/White-Heat/Rainbow/Iron-Red up to 17 modes
Lens Type	Fixed
Focus Control	Manual
Focal Length	8mm, F1.0
AFoV	46° x 35°

VISIBLE CAMERA

Sensor	1/2.8" Sony® CMOS
Scanning	Progressive
Resolution	1080p [1,920 x 1,080]
Frame Rate	25fps
Shutter (AES)	1/5 ~ 1/20,000
Camera Format	Day/Night (IR Cut Filter)
WDR Range	True WDR 120db
Sensitivity	(F1.2, 1/5, AGC ON)
Color	0.1lux (0.01fc)
B/W	0.01lux (0.001fc)
Lens	2.8 to 12mm motorized focus and zoom
Aperture	F1.6 -> F2.9
HAFOV	105° ~ 32°

IP STREAM

Video Streams	Two (2) Video Streams
Video Codec	H.265, H.264, MJPEG
Video Data Rate	Up to 8Mbs
Video Rate Cntrl	Variable or Constant

EMBEDDED INTELLIGENCE

Smart Alarm	Motion detection, Disk alarm, I/O alarm, Temperature alarm, IVS alarm
IVS	Smart Body Detection, Perimeter, Single Virtual Fences, Double Virtual Fences, Object Left, Object Removed

NETWORK INTERFACE

Ethernet	RJ-45 (10/100Base-T)
Protocols:	IPv4/IPv6, HTTP, RTSP/RTP/RTCP, TCP/UDP, DHCP, DNS, PPPoE, SMTP, SIP, 802.1x
Interoperability	ONVIF Profile G, CGI, SDK
Streaming Method	Unicast
Max. User Access	10 Users
Edge Storage	NAS, Local PC for instant recording
Web Viewer	Chrome, Firefox
Web Language	English, Chinese, Polish, Italian, Portuguese, Spanish, Russian, French, Czech, Hungarian

TEMPERATURE DETECTION

Detection Mode	Body temperature monitoring
Temperature Alarm	Over temperature alarm, Temperature difference alarm
Accuracy	≤ 0.3°C (Emission rate, distance, ambient temperature, etc.)
Response Time	≤30ms
Temp Range	-20° ~ 60°C (-4° ~ 140°F)

ELECTRICAL

Input Voltage	12VDC/PoE (IEEE 802.3af)
Power	10W

MECHANICAL

Weight	4.4lbs (2kg) Camera
Dimensions	182(W) x 136(H) x 212(D)mm 8.35(W) x 5.35(H) x 8.35(D)in.
Construction	Metal

ENVIRONMENTAL

Protection Rating	IP66
Operating Temp	-30° ~ 60°C (-22° ~ 140 °F)
Storage Conditions	0 ~ 90% RH

3212-9000 THERMAL CALIBRATION REFERENCE DEVICE

THERMAL CALIBRATION

Measurement Range	5° ~ 50°C (50° ~ 122°F)
Emissive Area	70mm x 70mm
Accuracy	+/-0.2° @ 40°C +/-0.36° @ 104°F
Stability	+/- 0.1° ~ 0.2°C / 30min +/- 0.18° ~ 0.36°F / 30min
Emissivity	.97 +/- 0.02

ELECTRICAL

Power Supply	110-240VAC, 50/60Hz, 1.3A
Blackbody	24VDC, 3.75A, 90W max

MECHANICAL

Weight	1.8kg (3.97lbs)
Dimensions	110(W) x 120(H) x 180(D)mm 4.3(W) x 4.72(H) x 7.1(D)in.

ENVIRONMENTAL

Operating Temp.	0° ~ 40°C (2° ~ 104°F)
Humidity	< 80% N.C.

COMPLETE SOLUTION

CERTIFICATIONS

CE, FCC, NDAA Compliant
[Not intended for medical use]

ORDERING INFORMATION

3212-2001 Thermal/Visible Dual Sensor Camera
3212-9000 Thermal Calibration Reference Device

ACCESSORIES

7411801-001 Wall bracket
7411801-002 Telescopic Ceiling Bracket
7411801-004 Heavy duty tripod

3212-2000 DIMENSIONS

Dimension	3212-2000	
	Inches	mm
A	7.17	182
B	5.35	136
C	8.35	212

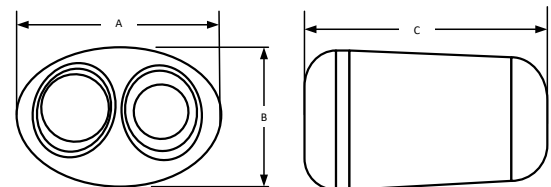

youtube.com/CohuHD
linkedin.com/company/CohuHD
twitter.com/CohuHD
facebook.com/CohuHD
CohuHD.com